

MODEL: 50AFU2.4;50AFU2.8 3Ø

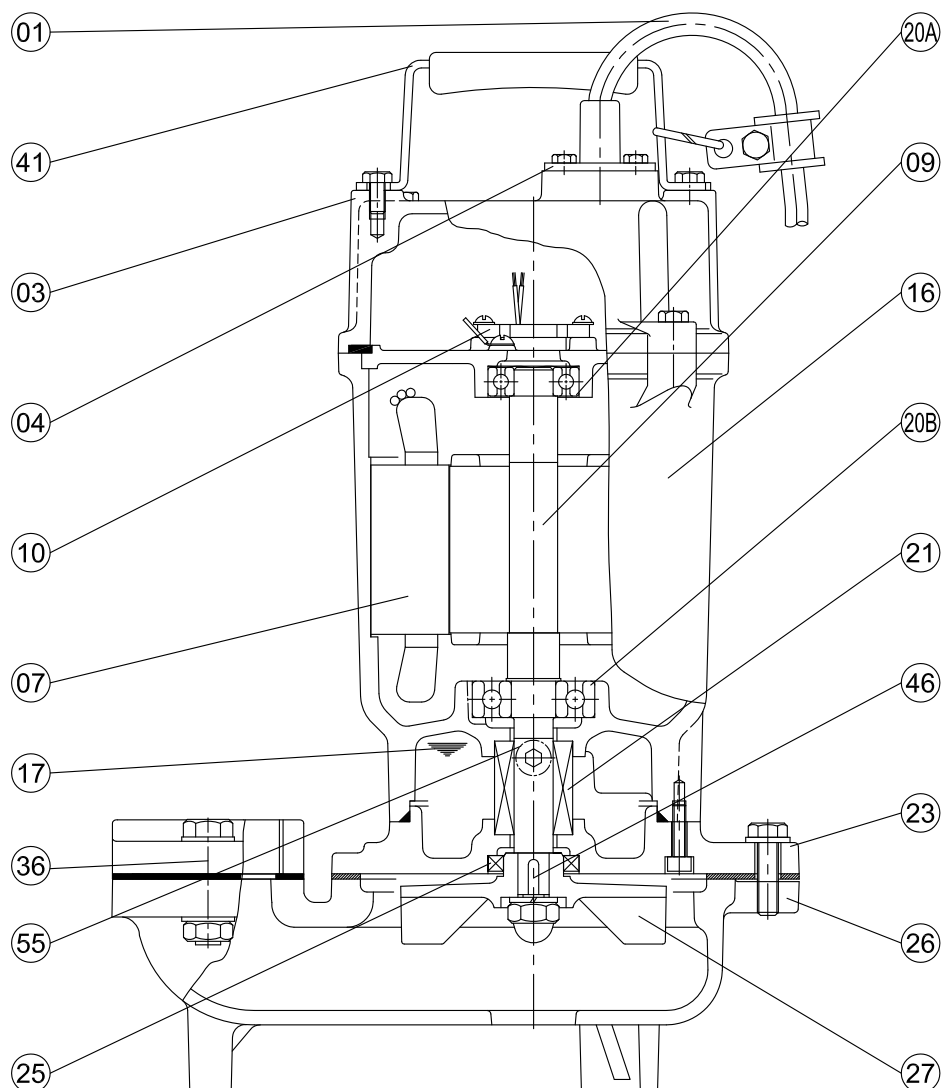

| No. | Part name | Material | QTY | Remark |
|-----|-------------------|------------------------|-----|-------------------------|
| 01 | Cable | | 1 | VCT/H07RN-F UL / CSA |
| 03 | Upper cover | FC-200 | 1 | |
| 04 | Cable base cover | SUS304 | 1 | |
| 07 | Stator | | 1 | |
| 09 | Shaft(with Rotor) | SUS403 | 1 | |
| 10 | Auto-cut | | 1 | |
| 16 | Motor frame | FC-200 | 1 | |
| 17 | Lubricant | Turbine oil #32 | 1 | |
| 20A | Upper bearing | | 1 | |
| 20B | Lower bearing | | 1 | |
| 21 | M. seal | CA VS CE SIC VS SIC | 1 | |

| No. | Part name | Material | QTY | Remark |
|-----|-----------------|----------|-----|--------|
| 23 | M. seal bracket | FC-200 | 1 | |
| 25 | Oil seal | NBR | 1 | |
| 26 | Casing | FC-200 | 1 | |
| 27 | Impeller | FC-200 | 1 | |
| 36 | Flange | FC-200 | 1 | |
| 41 | Handle | SUS304 | 1 | |
| 46 | Impeller key | SUS304 | 1 | |
| 47 | Packing (1 set) | | 1 | |
| 55 | Oil plug | SUS304 | 1 | |
| | | | | |
| | | | | |